

Standard Ballasts 18–58 W, 230 V

For compact fluorescent lamps
Shape: 28 x 41 mm

Vacuum-impregnated with polyester resin
Push-in terminal for leads: 0.5–1 mm²
For the automatic luminaire wiring:
IDC terminals for leads H05V-U 0.5
tw 130
Protection class I

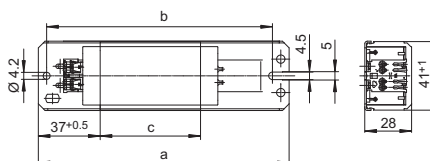
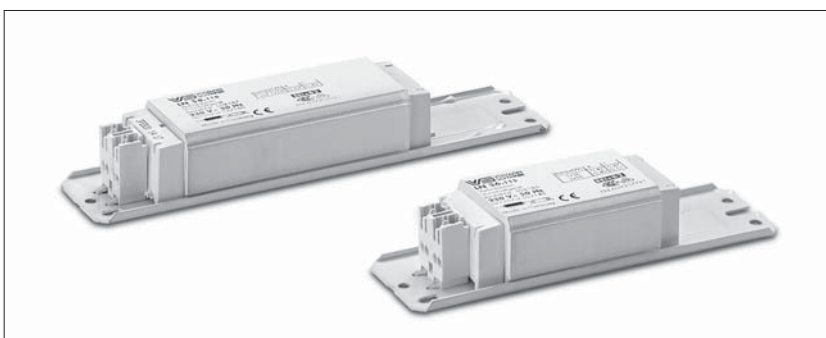

Lamp				Ballast									Capacitor	
Output W	Type	Base	Current mA	Type	Ref. No.	Voltage V, Hz	a mm	b mm	c mm	Weight kg	Δt/Δtan. K	Energy efficiency*	C _p μF	Current mA
230 V, 50 Hz														
18	TC-D/TC-T	G24d-2/GX24d-2	220	LN 181.940	508922	230, 50	85	75	34	0.32	50/120	B1	2.0	110
				LN 181.319	163763	230, 50	85	75	34	0.32	60/140	B1	2.0	110
	TC-F/TC-L	2G10/2G11	370	LN 18.510	164572	230, 50	155	140	92	0.80	40/65	B1	4.5	120
				LN 18.131	530941	230, 50	150	140	60	0.55	55/95	B2	4.5	120
	T-U	2G13	370	L 18.934**	534621	230, 50	150	140	45	0.43	70/150	–	4.5	120
				LN 18.131	530941	230, 50	150	140	60	0.55	55/95	B2	4.5	120
2x18	TC-F/TC-L	2G10/2G11	400	LN 2x18.135	532155	230, 50	150	140	45	0.43	65	B1	4.0	210
				L 36.334	530007	230, 50	150	140	60	0.55	60/155	B1	4.0	210
22	T-R	G10q	400	LN 30.530	164680	230, 50	155	140	92	0.80	45/65	B2	4.5	200
24	TC-F/TC-L	2G10/2G11	345	LN 24/26.804	534490	230, 50	150	140	60	0.55	55/110	B2	4.5	150
				L 18.934**	534621	230, 50	150	140	45	0.43	70/150	–	4.5	150
26	TC-D/TC-T	G24d-3/GX24d-3	325	LN 18.131	530941	230, 50	150	140	60	0.55	55/95	B1	3.5	140
				LN 26.813	509502	230, 50	110	100	45	0.41	55/145	B2	3.5	140
				L 18.934**	534621	230, 50	150	140	45	0.43	70/150	–	3.5	140
28	TC-DD	GR8/GR10q	320	LN 18.510	164572	230, 50	155	140	92	0.80	40/65	B1	3.5	150
				LN 18.131	530941	230, 50	150	140	60	0.55	55/95	B1	3.5	150
				L 18.934**	534621	230, 50	150	140	45	0.43	70/150	–	3.5	150
new 32	T-R	G10q	450	LN 36.570	169779	230, 50	155	140	92	0.80	35/90	B2	4.0	220
36	TC-F/TC-L	2G10/2G11	430	LN 36.570	169779	230, 50	155	140	92	0.80	35/90	B1	4.5	210
				LN 36.511	164590	230, 50	155	140	92	0.80	35/95	B1	4.5	210
				LN 36.130	527191	230, 50	150	140	60	0.55	50/140	B2	4.5	210
				LN 36.149	529029	230, 50	150	140	60	0.55	55/150	B2	4.5	210
				L 36.132**	535977	230, 50	150	140	45	0.43	65	–	4.5	210
36/40	T-U/TR	2G13/G10q	430	LN 36.570	169779	230, 50	150	140	92	0.80	35/90	B1	4.5	210
				LN 36.149	529029	230, 50	150	140	60	0.55	55/150	B2	4.5	210
				L 36.132**	535977	230, 50	150	140	45	0.43	65	–	4.5	210
38	TC-DD	GR10q	430	LN 36.570	169779	230, 50	155	140	92	0.80	35/90	B1	4.5	210
				LN 36.149	529029	230, 50	150	140	60	0.55	55/150	B2	4.5	210
				L 36.132**	535977	230, 50	150	140	45	0.43	65	–	4.5	210
new 58	T-U	2G13	670	LN 58.568	169389	230, 50	233	220	160	1.31	35/95	B1	7.0	320
				LN 58.990	509349	230, 50	190	180	110	0.95	50/130	B2	7.0	320
				LN 58.116	508186	230, 50	190	180	92	0.80	55/160	B2	7.0	320
				L 58.718**	169658	230, 50	190	180	92	0.80	60/170	–	7.0	320

* Energy efficiency: EEI=B2 and EEI=B1, valid until 2017

** Ballasts without CE mark for markets outside of the EU

1

2

3

4

5

6

7

8

9

10

Standard Ballasts

18–58 W, 240 V

For compact fluorescent lamps
Shape: 28 x 41 mm

Lamp				Ballast									Capacitor	
Output	Type	Base	Current	Type	Ref. No.	Voltage	a	b	c	Weight	$\Delta t/\Delta t_{on}$	Energy efficiency*	C _p	Current
W			mA			V, Hz	mm	mm	mm	kg	K		μF	mA
240 V, 50 Hz														
18	TC-D/TC-T	G24d-2/GX24d-2	220	LN 18.148	164353	240, 50	85	75	34	0.28	60/130	B1	2.0	110
				LN 18.507	164566	240, 50	155	140	92	0.80	35/60	B1	4.5	120
					533043	240, 50	150	140	60	0.55	60/110	B2	4.5	120
	T-U	2G13	370	L 18.936**	534627	240, 50	150	140	45	0.43	70/140	–	4.5	120
				LN 18.507	164566	240, 50	155	140	92	0.80	35/60	B1	4.5	120
				LN 18.162	533043	240, 50	150	140	60	0.55	60/110	B2	4.5	120
2x18	TC-F/TC-L	2G10/2G11	400	LN 2x18.135	535778	240, 50	150	140	45	0.43	65	B1	4.0	210
				L 36/40.443	530008	240, 50	150	140	60	0.55	65/155	B1	4.0	210
				LN 36.201	527196	240, 50	150	140	60	0.55	55/140	B1	4.0	210
				LN 36.505	164555	240, 50	155	140	92	0.80	40/95	B1	4.0	210
21	TC-DD	GR10q	260	LN 21.293	547145	240, 50	105	95	45	0.41	55	B1	3.0	120
24	TC-F/TC-L	2G10/2G11	345	LN 18.507	164566	240, 50	155	140	92	0.80	35/60	B1	4.5	150
				LN 18.162	533043	240, 50	150	140	60	0.55	60/110	B2	4.5	150
				L 18.936**	534627	240, 50	150	140	45	0.43	70/140	–	4.5	150
26	TC-D/TC-T	G24d-3/GX24d-3	325	LN 18.162	533043	240, 50	150	140	60	0.55	60/110	B1	4.5	150
				LN 26.238	545405	240, 50	105	95	45	0.41	55/145	B2	3.5	140
28	TC-DD	GR8/GR10q	320	LN 18.162	533043	240, 50	150	140	60	0.55	60/110	B1	3.5	150
				L 18.936**	534627	240, 50	150	140	45	0.43	70/140	–	3.5	150
32	T-R	G10q	450	LN 36.505	164555	240, 50	155	140	92	0.80	40/95	B1	4.0	220
36	TC-F/TC-L	2G10/2G11	430	LN 36.505	164555	240, 50	155	140	92	0.80	40/95	B1	4.5	210
				LN 36.201	527196	240, 50	155	140	60	0.55	55/140	B2	4.5	210
				L 36/40.443**	164438	240, 50	150	140	60	0.55	65/155	–	4.5	210
36/40	T-U/TR	2G13/G10q	430	LN 36.505	164555	240, 50	155	140	92	0.80	40/95	B1	4.5	210
				LN 36.201	527196	240, 50	150	140	60	0.55	55/140	B2	4.5	210
				L 36/40.443**	164438	240, 50	150	140	60	0.55	65/155	–	4.5	210
38	TC-DD	GR10q	430	LN 36.201	527196	240, 50	150	140	60	0.55	55/140	B2	4.5	210
				L 36/40.443**	164438	240, 50	150	140	60	0.55	65/155	–	4.5	210
58	T-U	2G13	670	LN 58.506	164560	240, 50	233	220	160	1.31	35/85	B1	7.0	320
				LN 58.192	507936	240, 50	190	180	110	0.95	50/150	B2	7.0	320
				LN 58.722	534252	240, 50	190	180	92	0.80	60/180	B2	7.0	320

* Energy efficiency: EEI=B2 and EEI=B1, valid until 2017

** Ballasts without CE mark for markets outside of the EU